

Unit J1

F1r: 2

Dwg # RS -1801 J1.1

No:	Date:	Revisions:	By:

Customer: The Rinaldi Group
 Project: 75 Kenmare Street
 Title: Kitchen - Unit J1 - Elevation 1
 Date: 10-01-18 Scale: NONE

Red Star Cabinet Co Inc
 226 Sherwood Avenue, Suite A
 Farmingdale, New York 11735
 631 694 6200

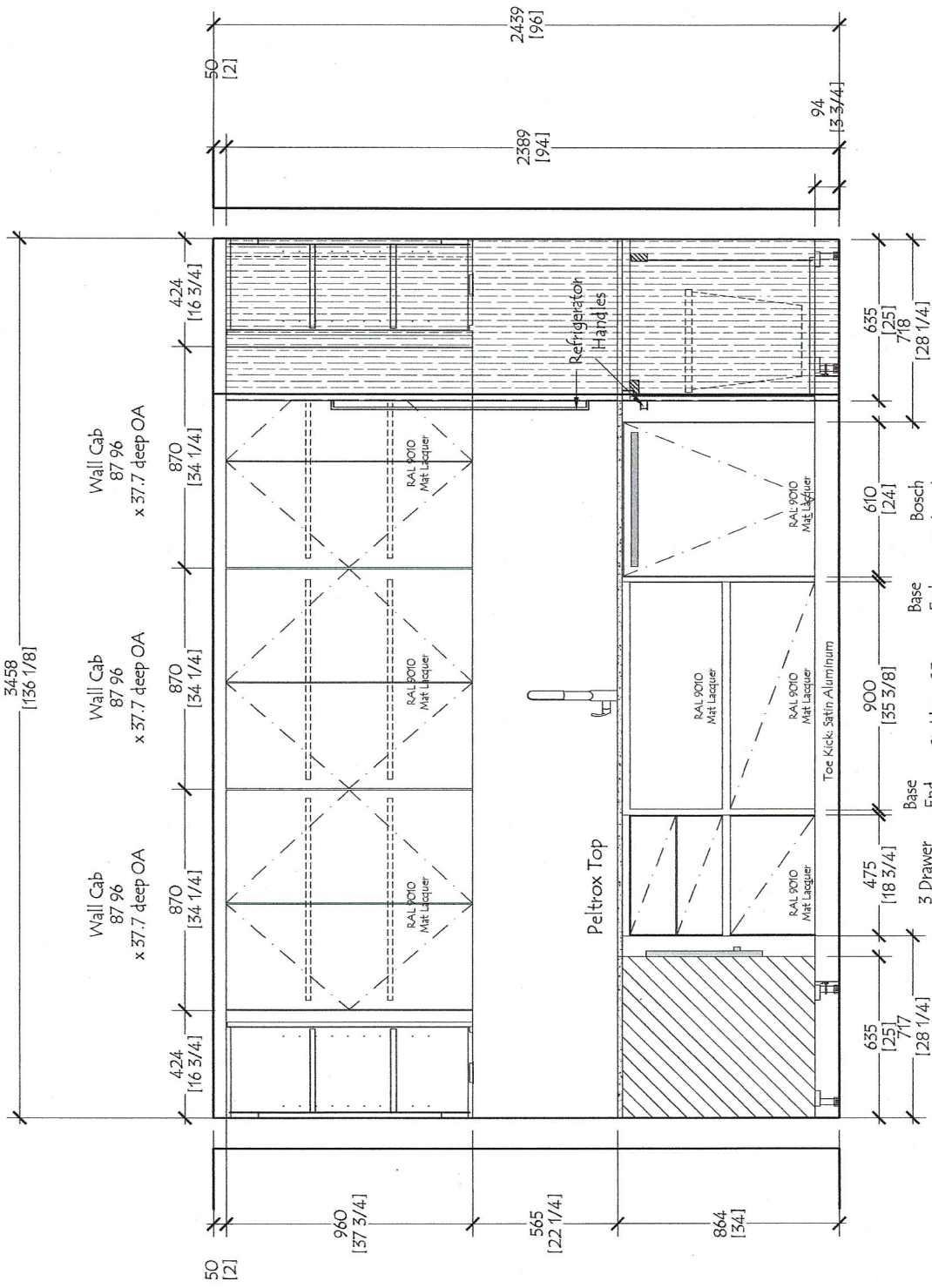

Unit J1

F1r: 2

Dwg # RS -1801
J1.2

No:	Date:	Revisions:	By:

Customer: The Rinaldi Group
 Project: 75 Kenmare Street
 Title: Kitchen - Unit J1 - Elevation 2
 Date: 10-01-18 Scale: NONE

Red Star Cabinet Co Inc
 226 Sherwood Avenue, Suite A
 Farmingdale, New York 11735
 631 694 6200

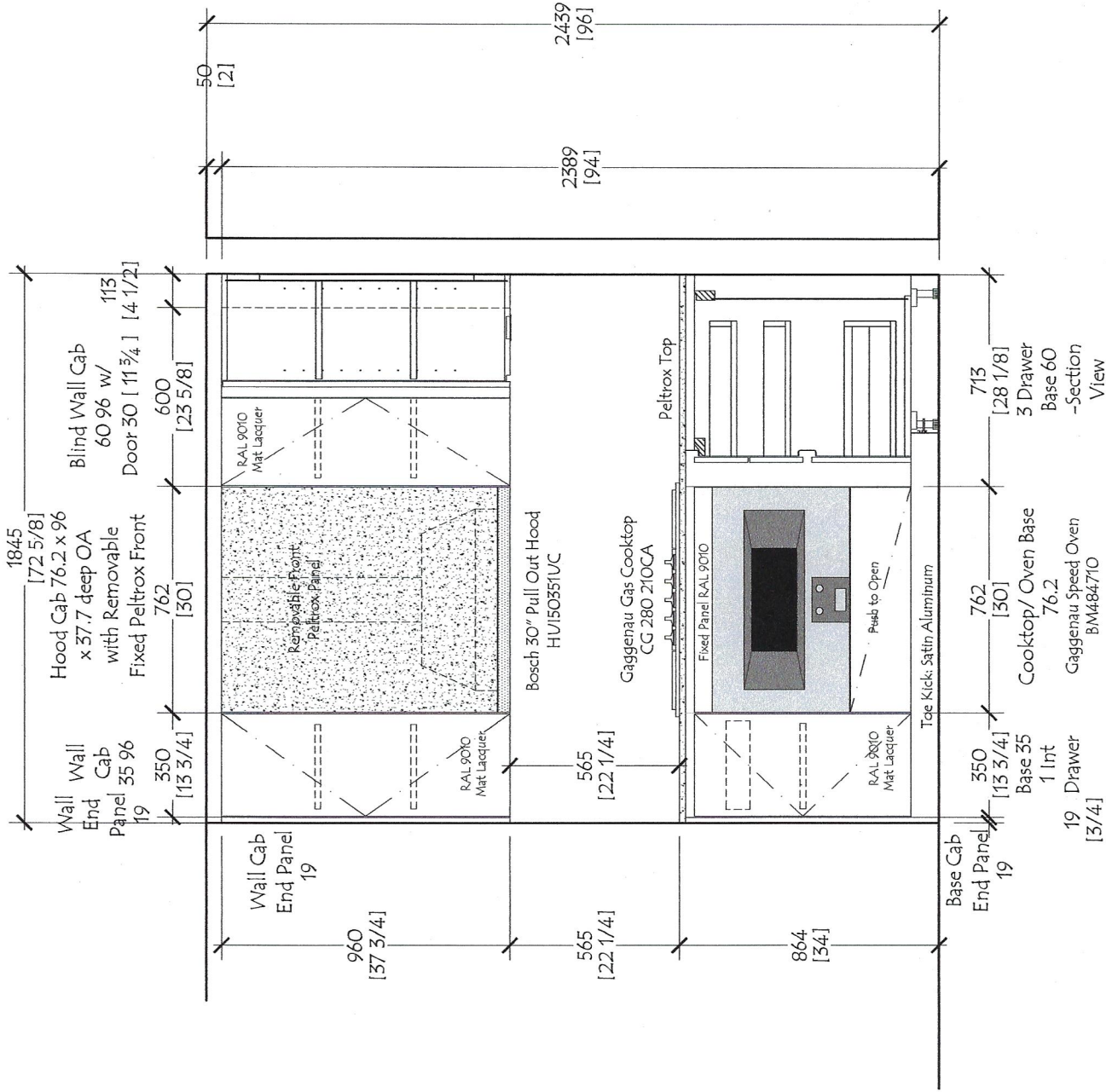

Unit J1

Flr: 2

No:	Date:	Revisions:	By:

Customer: The Rinaldi Group
 Project: 75 Kenmare Street
 Title: Kitchen - Unit J1 - Elevation 3
 Date: 10-01-18 Scale: NONE

Red Star Cabinet Co Inc
 226 Sherwood Avenue, Suite A
 Farmingdale, New York 11735
 631 694 6200

Dwg # RS -1801
 J1.3

Wall Cab
End Panel 19
960 high
377 deep

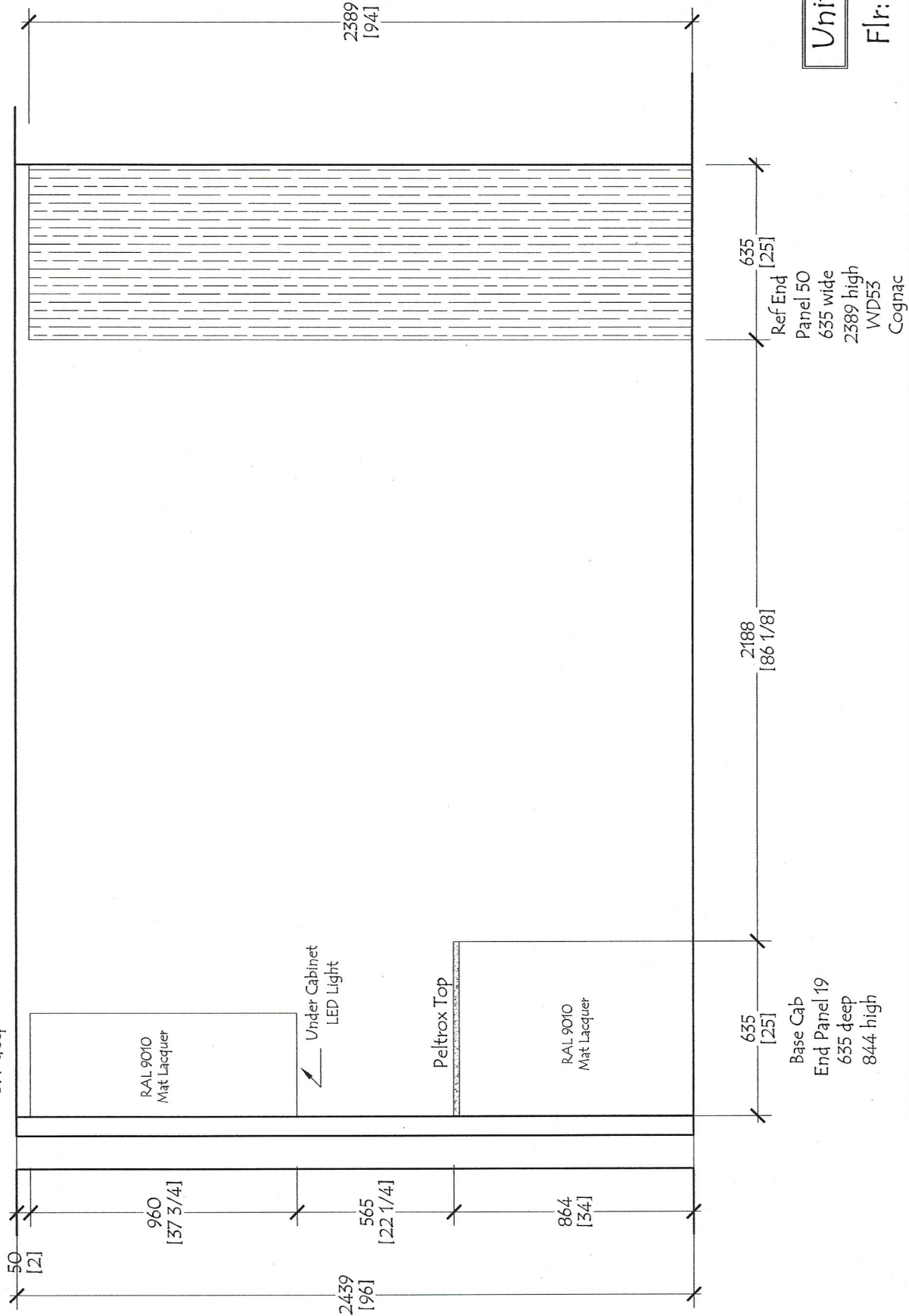

Unit J1

F1r: 2

Red Star Cabinet Co Inc 226 Sherwood Avenue, Suite A Farmingdale, New York 11735 631 694 6200		Customer: The Rinaldi Group	
		Project: 75 Kenmare Street	
		Title: Kitchen - Unit F3 - Elevation 4	
		Date: 10-01-18 Scale: NONE	
No:	Date:	Revisions:	By:
Dwg # RS -1801 J1.4			

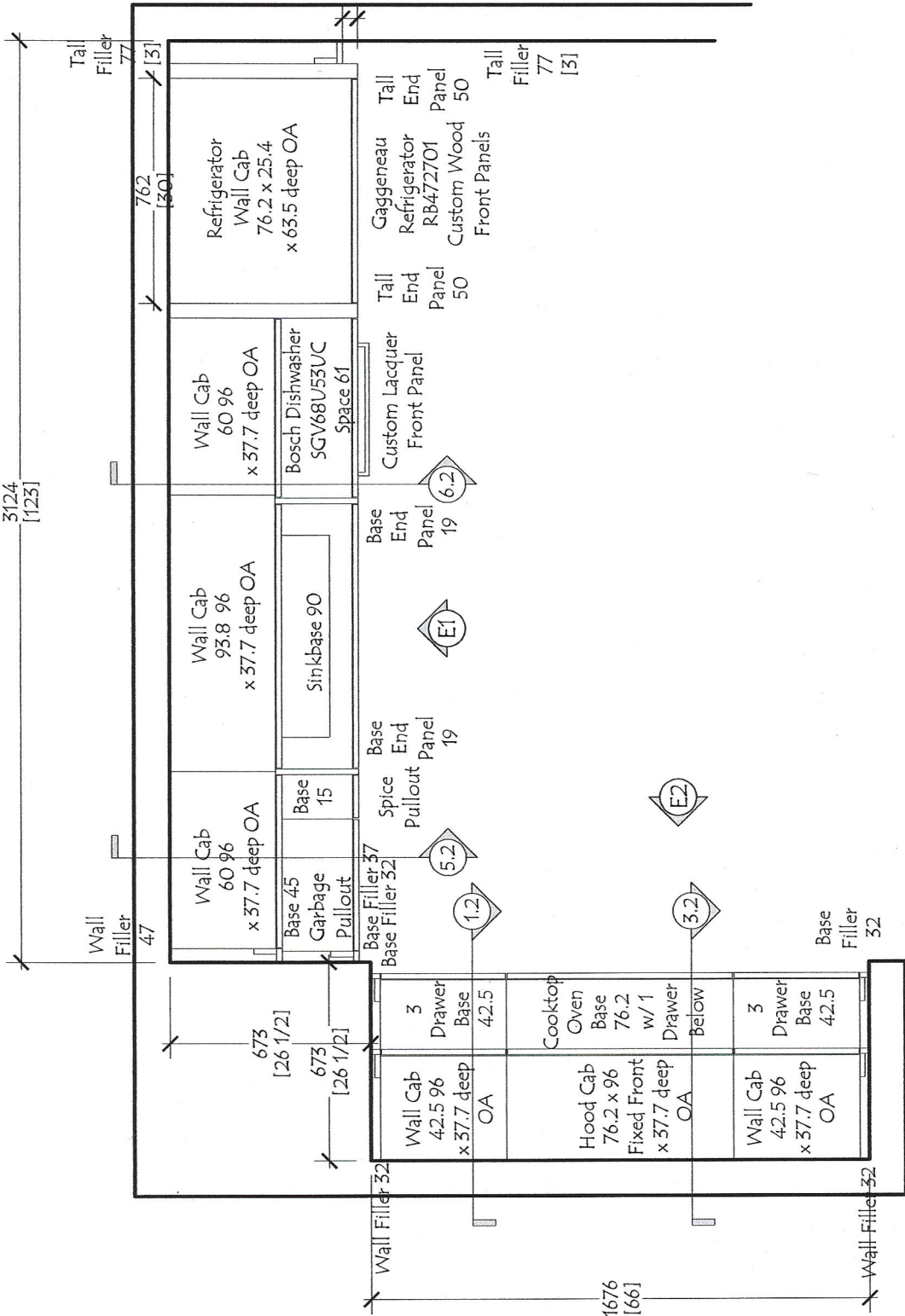

Unit J2 - Package A
 Flr 3
 Quantity: (1)
 Ceiling Ht 96" at Floor 3

Dwg #
 RS -1801
 J2f3

No:	Date:	Revisions:	By:

Customer: The Rinaldi Group
 Project: 75 Kenmare Street
 Title: Kitchen - Plan View - Unit J2
 Date: 10-01-18 Scale: NONE

Red Star Cabinet Co Inc
 226 Sherwood Avenue, Suite A
 Farmingdale, New York 11735
 631 694 6200

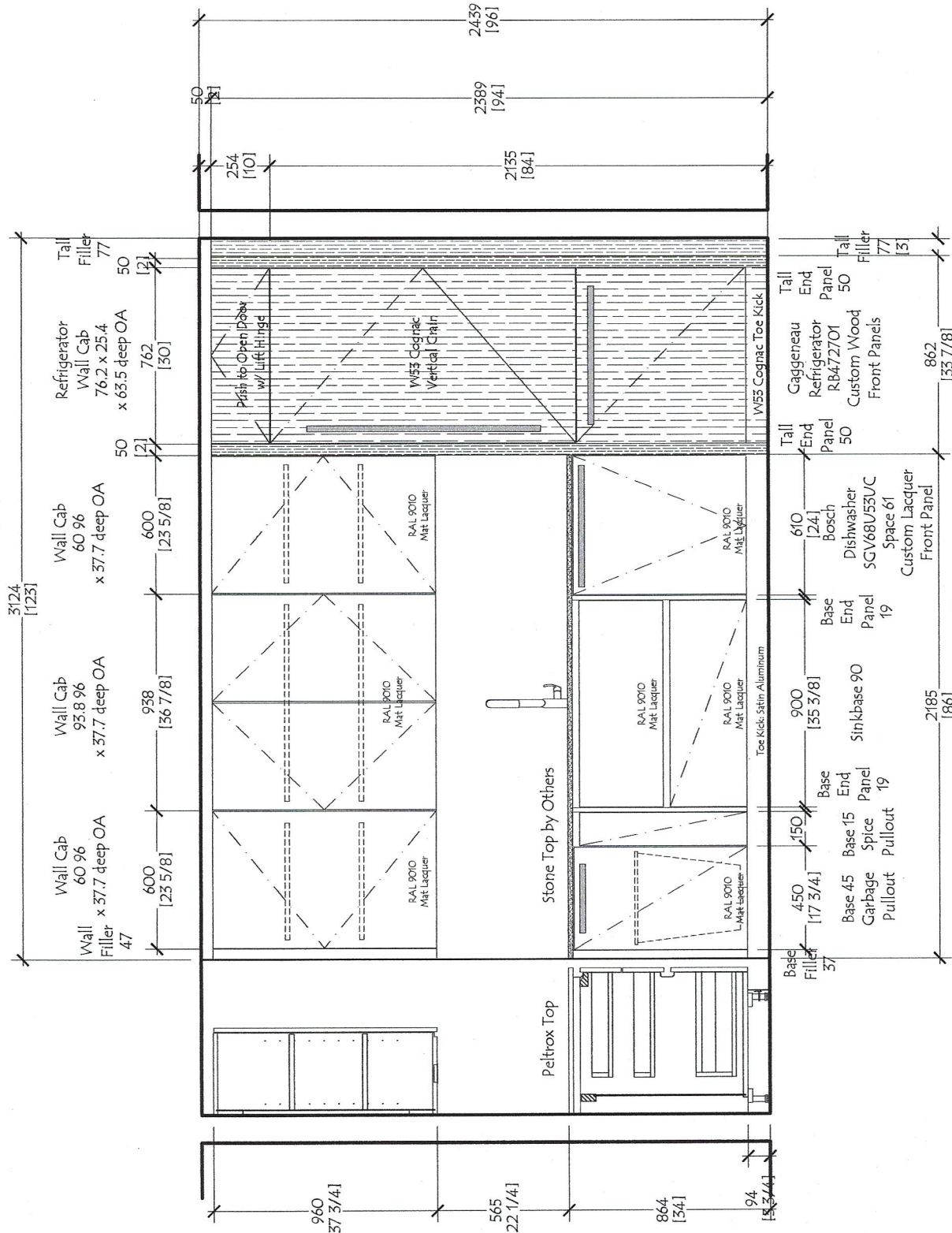

Unit J2
Flr: 3

Dwg #
RS -1801
J2f3.1

No:	Date:	Revisions:	By:

Customer: The Rinaldi Group
 Project: 75 Kenmare Street
 Title: Kitchen - Unit J2f3 - Elevation 1
 Date: 10-01-18 Scale: NONE

Red Star Cabinet Co Inc
 226 Sherwood Avenue, Suite A
 Farmingdale, New York 11735
 631 694 6200

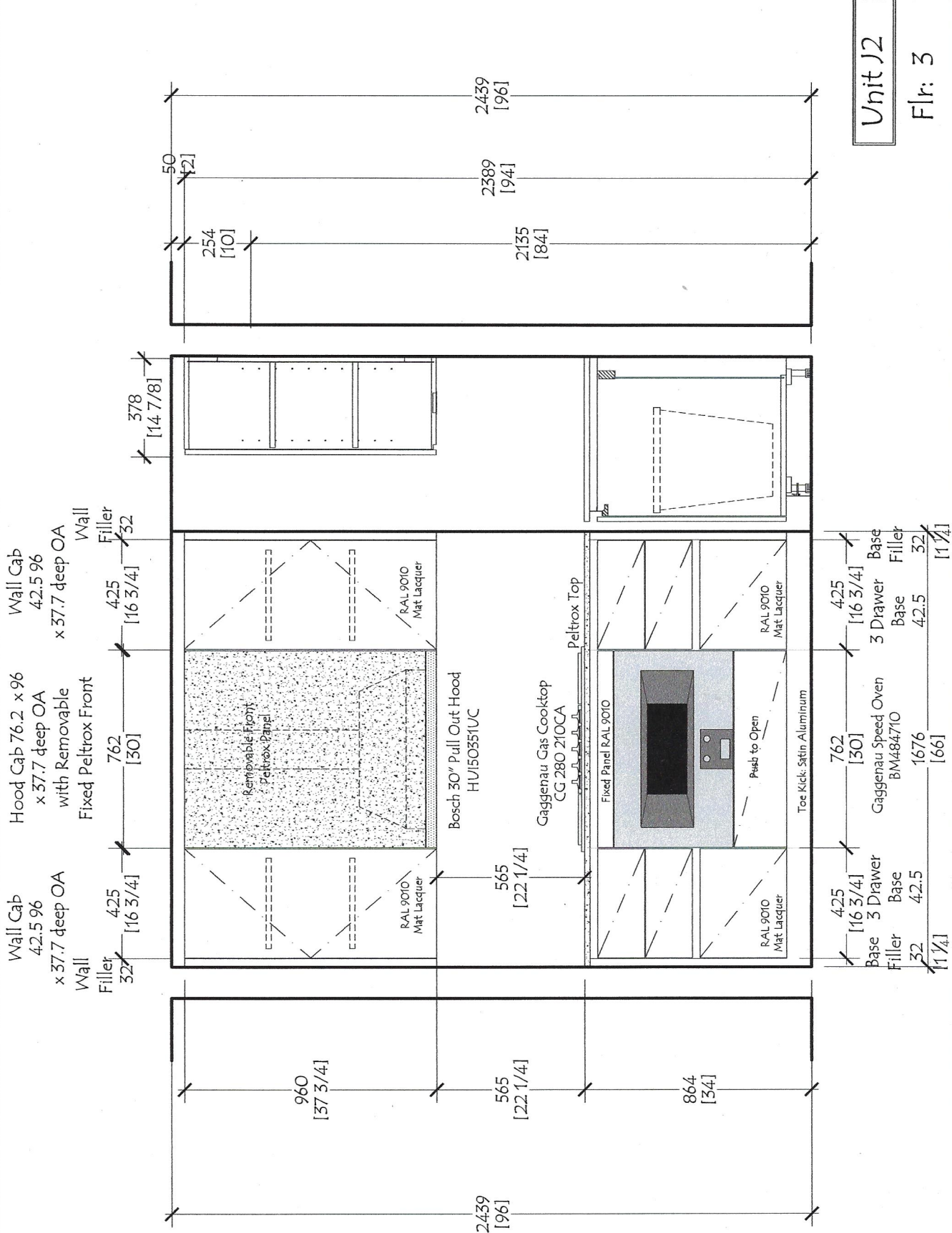

Unit J2

Flr: 3

Dwg #	RS -1801
	J2f3.2

No:	Date:	Revisions:	By:

Customer:	The Rinaldi Group
Project:	75 Kenmare Street
Title:	Kitchen - Unit J2f3 - Elevation 2
Date:	10-01-18
Scale:	NONE

Red Star Cabinet Co Inc
 226 Sherwood Avenue, Suite A
 Farmingdale, New York 11735
 631 694 6200

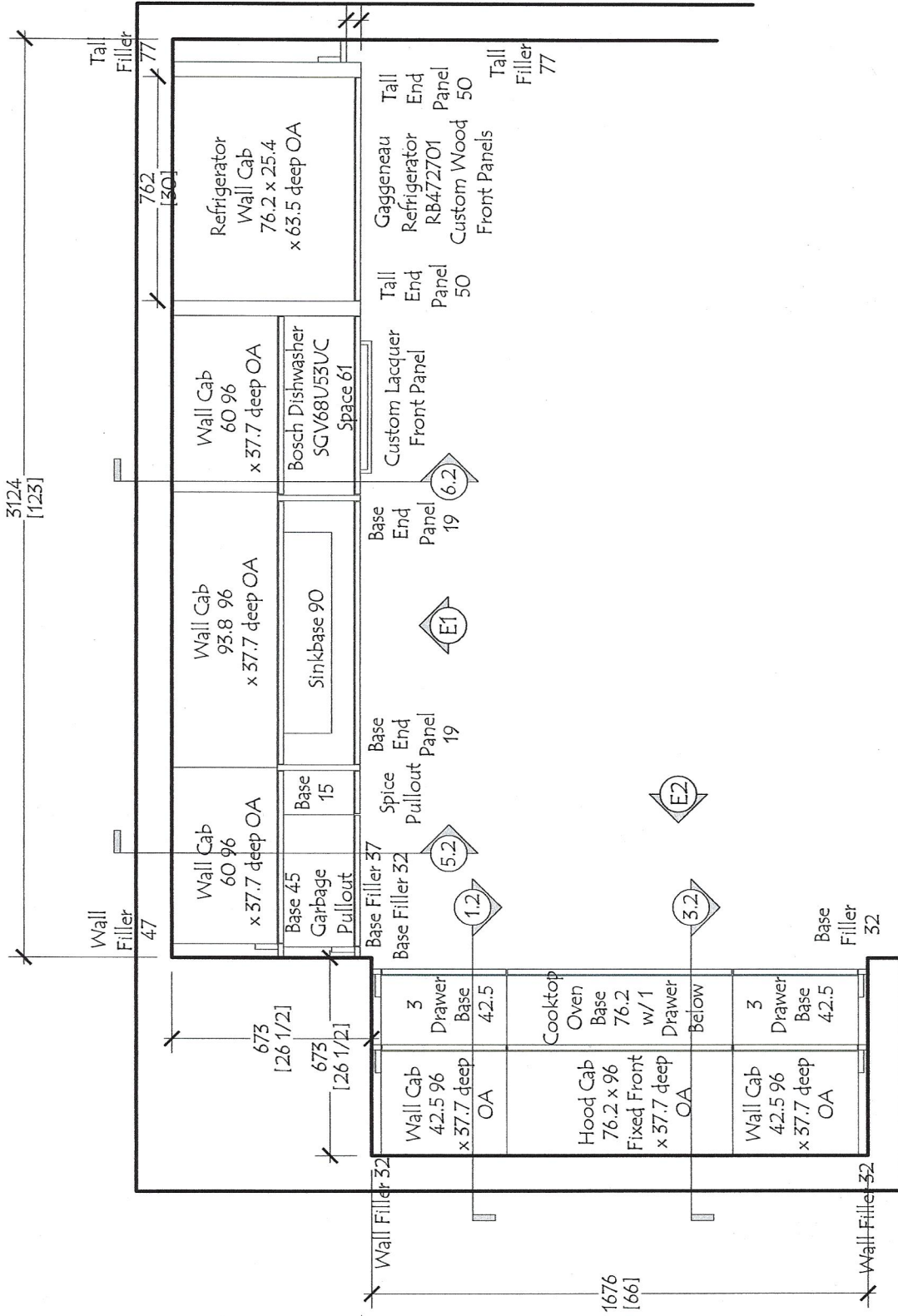

Unit J2 - Package A
 Flr 4
 Quantity: (1)
 Ceiling Ht 98" at Floor 4

Red Star Cabinet Co Inc 226 Sherwood Avenue, Suite A Farmingdale, New York 11735 631 694 6200		Customer: The Rinaldi Group Project: 75 Kenmare Street Title: Kitchen - Plan View - Unit J2f4 Date: 10-01-18 Scale: NONE		Dwg # RS -1801 J2f4	
No:	Date:	Revisions:	By:		

Unit J2

F1r: 4

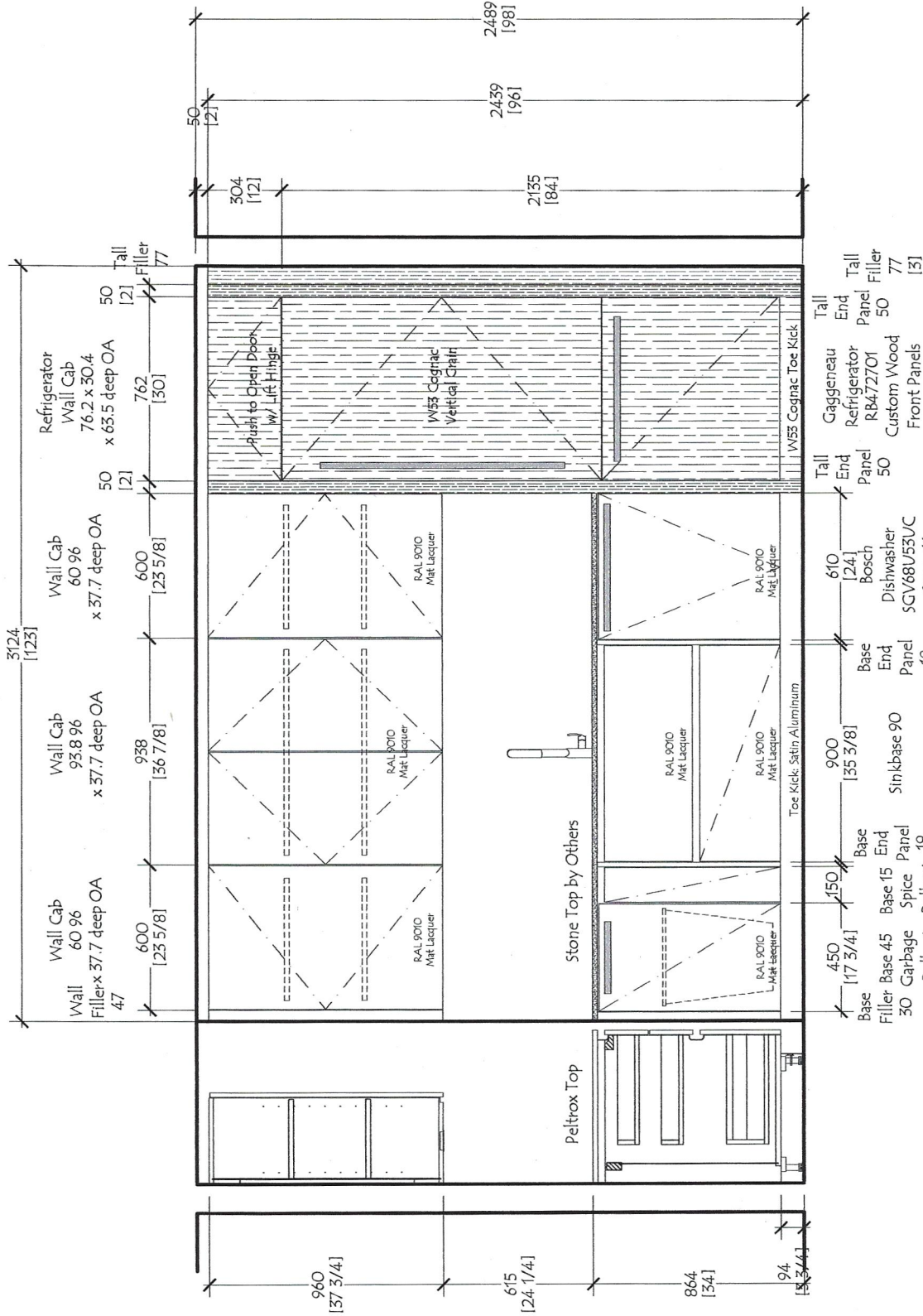

No:	Date:	Revisions:	By:

Customer: The Rinaldi Group
 Project: 75 Kenmare Street
 Title: Kitchen - Unit J2f4- Elevation 1
 Date: 10-01-18 Scale: NONE

Red Star Cabinet Co Inc
 226 Sherwood Avenue, Suite A
 Farmingdale, New York 11735
 631 694 6200

Dwg #
RS -1801
J2f4.1

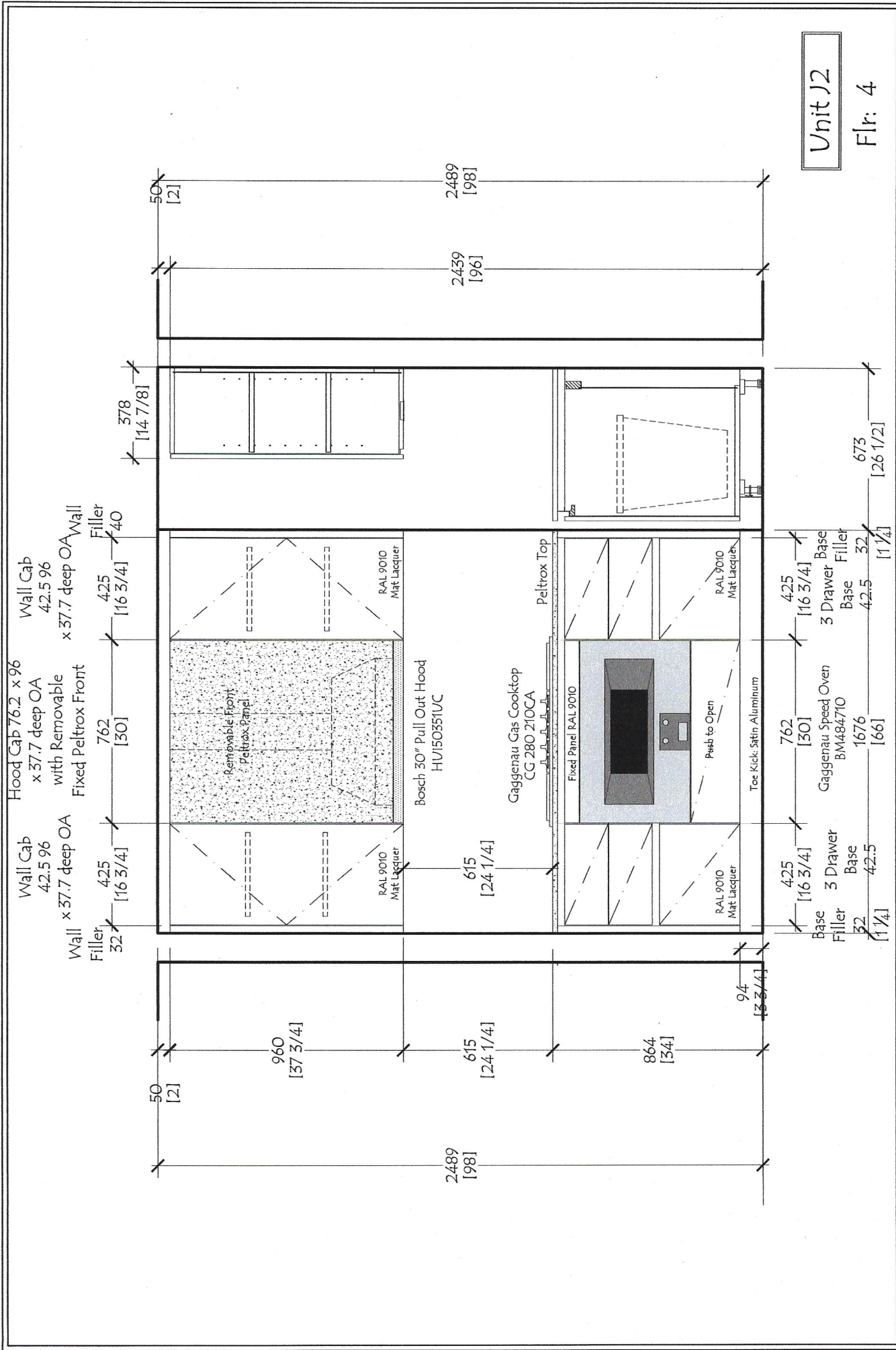

Red Star Cabinet Co Inc 226 Sherwood Avenue, Suite A Farmingdale, New York 11735 631 694 6200		Customer: The Rinaldi Group	
Project: 75 Kenmare Street		No:	
Title: Kitchen - Unit J2f4 - Elevation 2		Date:	
Date: 10-01-18		Revisions:	
Scale: NONE		By:	
Dwg #		RS -1801	
J2f4.2			

General Specifications:

Custom Italian Kitchen Cabinetry

Melamine Construction / Interiors

All exposed edges are banded for moisture protection

All Lacquer Cabinetry is Hand Sprayed

Cabinets are the Effetti L'Evolutione Collection in dual Finishes.

Base Cabinets have Slab Doors and Drawer Fronts with Square Edges with a Matching Lacquer G-Bar Reveal for Opening

Soft Close Full Extension Drawer Boxes with Inox Finish

Base Cabinet with Waste Pullout has Brick Design Handle in Stainless Steel Finish to Open

Base Cabinets have Adjustable Legs with Toe Fronts of Aluminum with Satin Finish

Wall Cabinet Doors have Square Edges and Open with Aluminum Groove at Bottom Front Edge of Cabinet Profile

Wall Cabinets have Recessed disc type LED - 2700K Warm - Undercabinet Lighting

All Cabinets have Soft Close Door Hinges

Base and Wall Cabinet Doors, Drawer Fronts, DW Panel, End Panels, Back Panels and Fillers

Finish: White Lacquer - RAL 9010 - Matte Finish

Pantry Cabinets have Slab Doors with Brick Design Handle in Stainless Steel Finish

Upper Cabinets Above the Pantrys and Refrigerators have Push to Open with Lift Hinge.

Refrigerator/Freezer and Dishwasher Custom Wood Front Panels are Slab Doors

with Square Edges and Brick Design Handle in Stainless Steel Finish to Open

Pantry Cabinets and Refrigerator Cabinets, Ref Front Panels, Ref End Panels, Tall Fillers,

Wall End Panels (End Caps), and Pantry, Refrigerator Toe Front

Finish: WD53 - Cognac Oak as per Approved Sample

Grain Direction: Vertical

Wood Bar Top at Back of Island/Peninsula

Finish: WD53 - Cognac Oak as per Approved Sample

Countertop at Range Wall Base Cabinets and the Front Panel at the Hood Cabinet Above Range are finished with Peltrox Metal #0106 "Chiaro Tarlato"

Appliance Schedule:
Package A and Package B:

Gaggenau 30" Refrigerator /Bottom Freezer RB472701 with Custom Wood Front Panels

Gaggenau 30" Gas Cooktop CG 280 210CA

Bosch 30" Pull Out Hood HUI50351UC

Gaggenau Speed Oven BM484710

Bosch 24" Dishwasher SGV68U53UC with Custom Lacquer Front Panel

Appliance Schedule:
Package C and Package D:

Gaggenau 30" Refrigerator/Bottom Freezer RB472701 with Custom Wood Front Panels

Gaggenau 36" Gas Cooktop VG 295 214CA

Gaggenau 36" Hood AF210791 with Lowering Frame AA210490

Gaggenau 36" Single Oven EB 388 610

Gaggenau Microwave Drawer MW420620 Flush Inset Installation

Bosch 24" Dishwasher SGV68U53UC with Custom Lacquer Front Panel

General Specifications:

Custom Italian Kitchen Cabinetry

Melamine Construction / Interiors

All exposed edges are banded for moisture protection

All Lacquer Cabinetry is Hand Sprayed

Cabinets are the Effetti L'Evolutione Collection in dual Finishes.

Base Cabinets have Slab Doors and Drawer Fronts with Square Edges with a Matching Lacquer G-Bar Reveal for Opening

Soft Close Full Extension Drawer Boxes with Inox Finish

Base Cabinet with Waste Pullout has Brick Design Handle in Stainless Steel Finish to Open

Base Cabinets have Adjustable Legs with Toe Fronts of Aluminum with Satin Finish

Wall Cabinet Doors have Square Edges and Open with Aluminum Groove at Bottom Front Edge of Cabinet Profile

Wall Cabinets have Recessed disc type LED - 2700K Warm - Undercabinet Lighting

All Cabinets have Soft Close Door Hinges

Base and Wall Cabinet Doors, Drawer Fronts, DW Panel, End Panels, Back Panels and Fillers

Finish: White Lacquer - RAL 9010 - Matte Finish

Pantry Cabinets have Slab Doors with Brick Design Handle in Stainless Steel Finish

Upper Cabinets Above the Pantrys and Refrigerators have Push to Open with Lift Hinge.

Refrigerator/Freezer and Dishwasher Custom Wood Front Panels are Slab Doors

with Square Edges and Brick Design Handle in Stainless Steel Finish to Open

Pantry Cabinets and Refrigerator Cabinets, Ref Front Panels, Ref End Panels, Tall Fillers,

Wall End Panels (End Caps), and Pantry, Refrigerator Toe Front

Finish: WD53 - Cognac Oak as per Approved Sample

Grain Direction: Vertical

Wood Bar Top at Back of Island/Peninsula

Finish: WD53 - Cognac Oak as per Approved Sample

Countertop at Range Wall Base Cabinets and the Front Panel at the Hood Cabinet Above Range are finished with Peltrox Metal #0106 "Chiaro Tarlato"

Red Star Cabinet Co Inc
226 Sherwood Avenue, Suite A
Farmingdale, New York 11735
631 694 6200

Customer: The Rinaldi Group
Project: 75 Kenmare Street
Title: Kitchen - Notes and General Specifications
Date: 10-01-18 Scale: NONE

No:	Date:	Revisions:	By:

Dwg #
RS -1801
Notes